

# L'ARAPÈDE DE LA GARE FRIGORIFIQUE

Axonométrie du projet

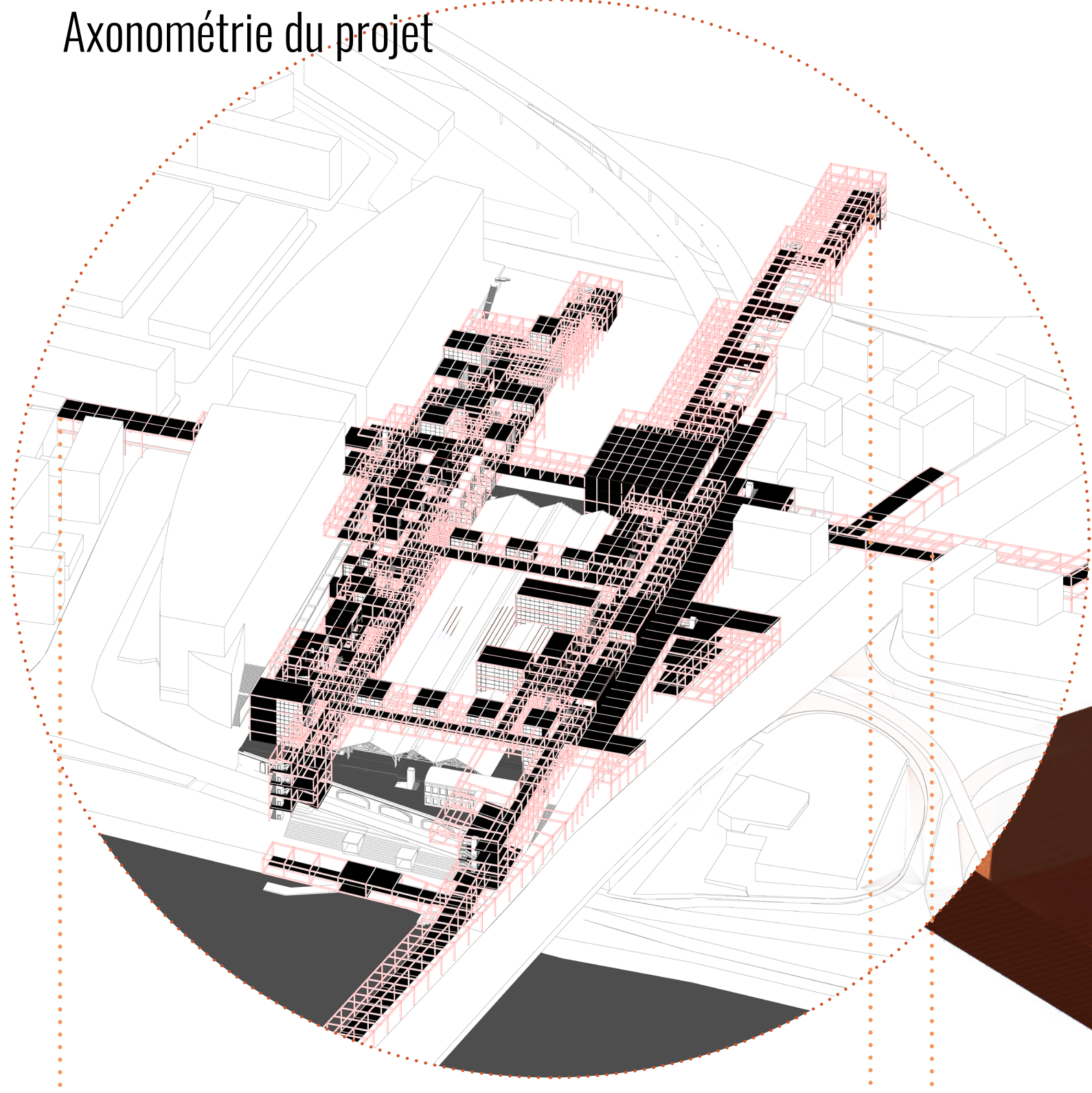

Grille du projet

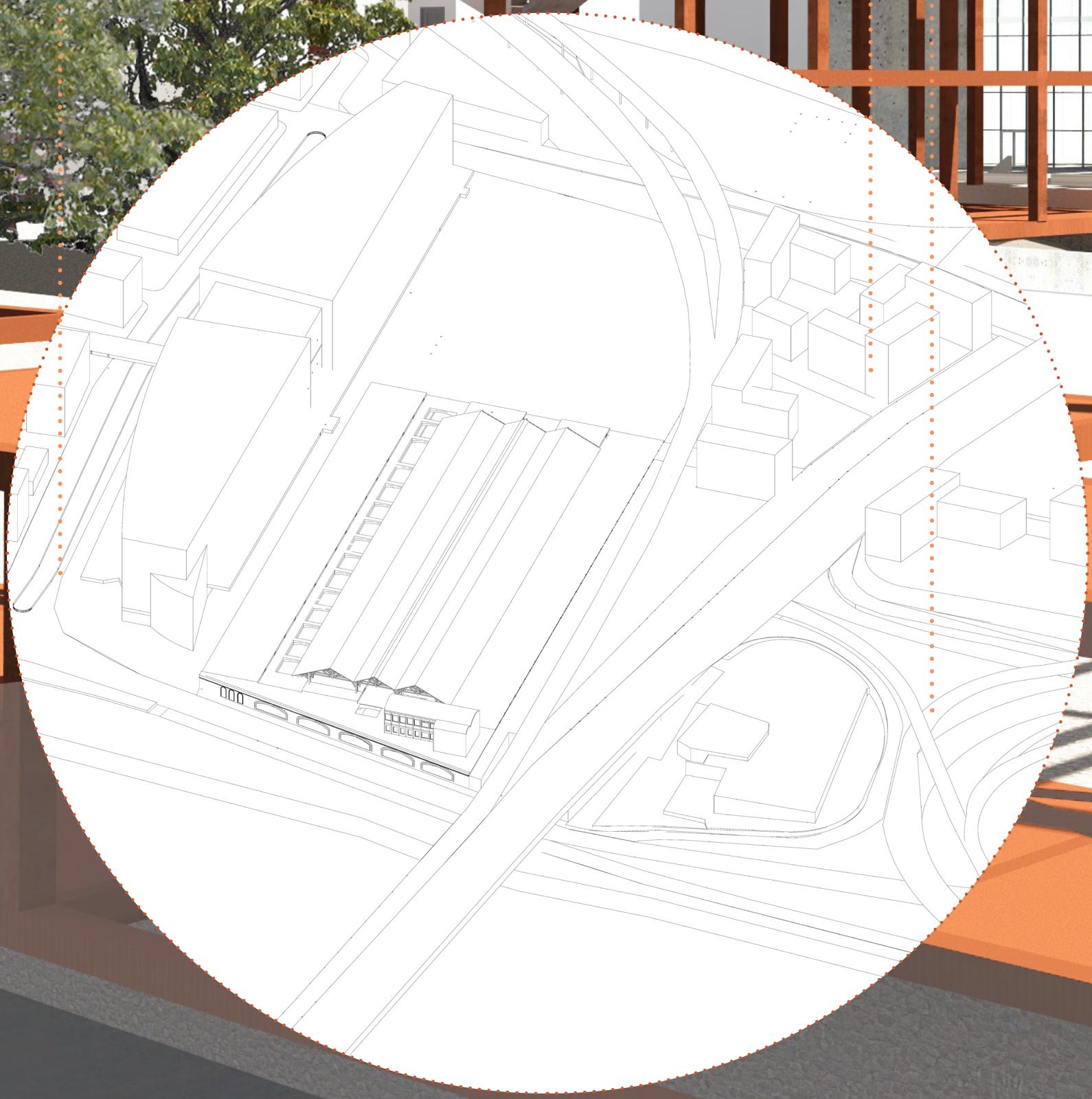
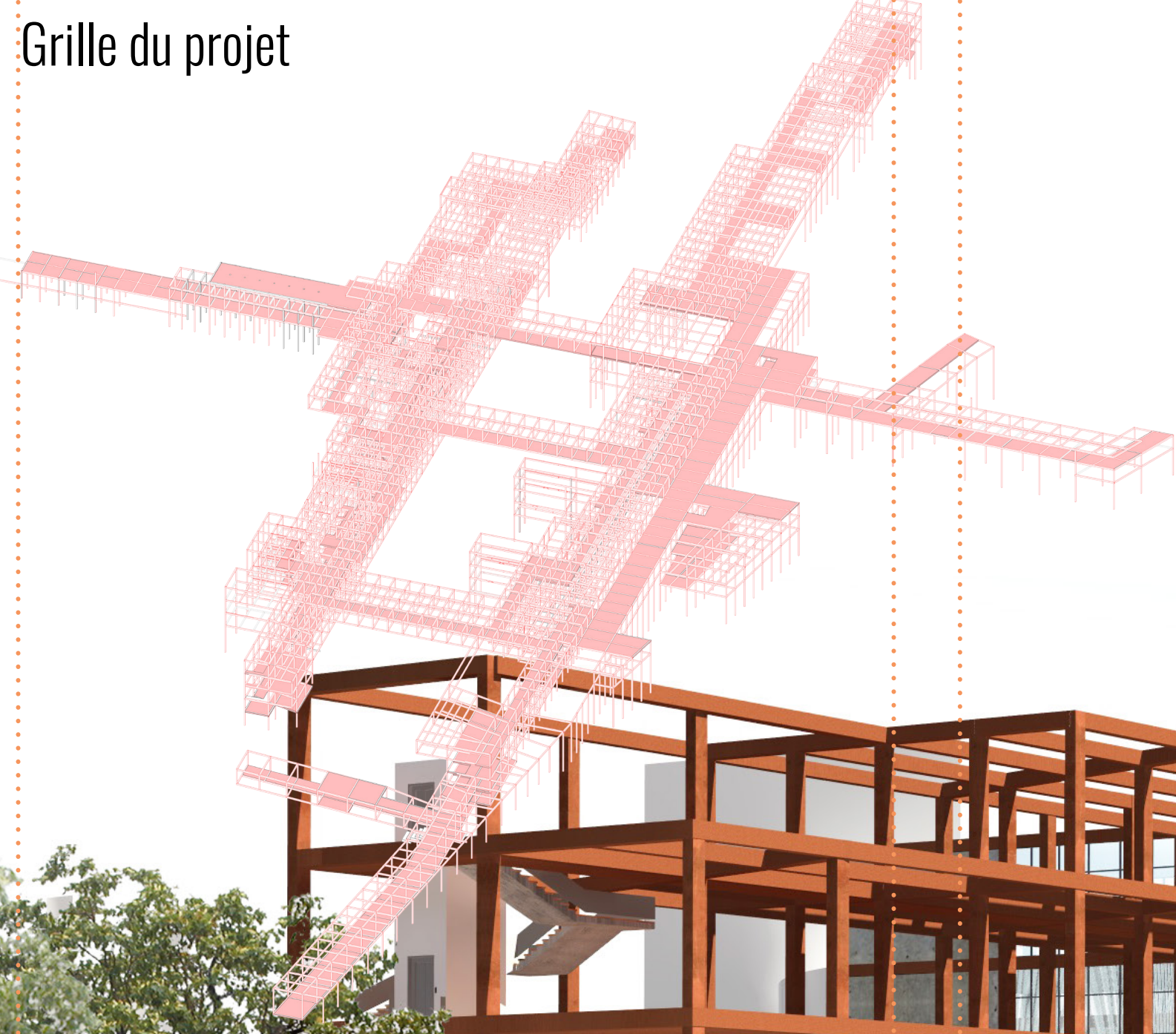

Gare frigorifique d'origine

module de logement 2 pièces

module de studio de danse

module de logement 4 pièces

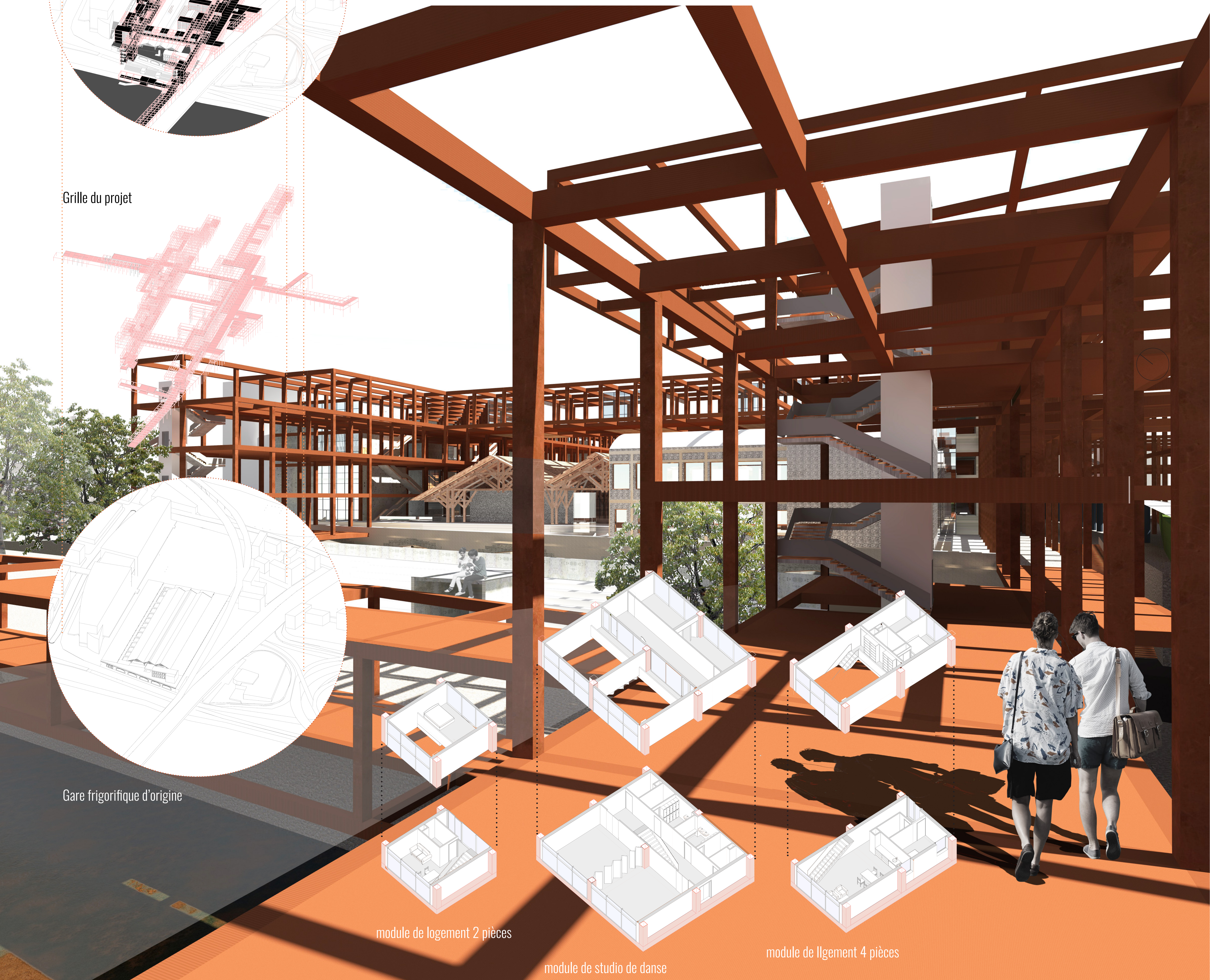

COUPE PERSPECTIVE TRANSVERSALE

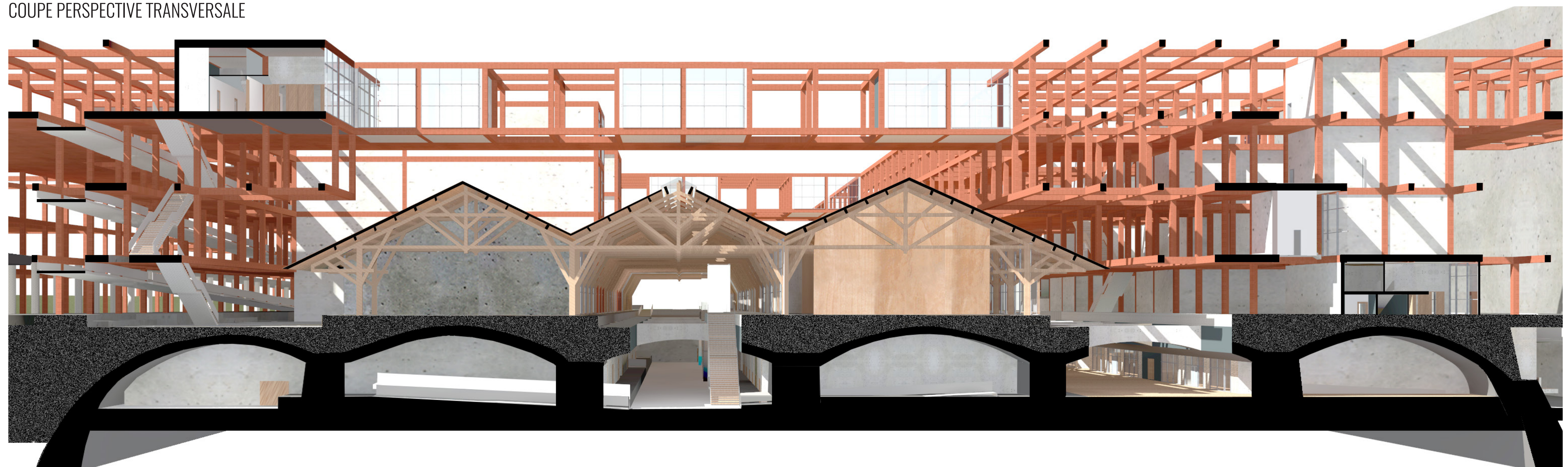

SOPHIE LOYER - ALESSANDRO MOSCA - DE 6 -S9/S10-2017